

用地红线图

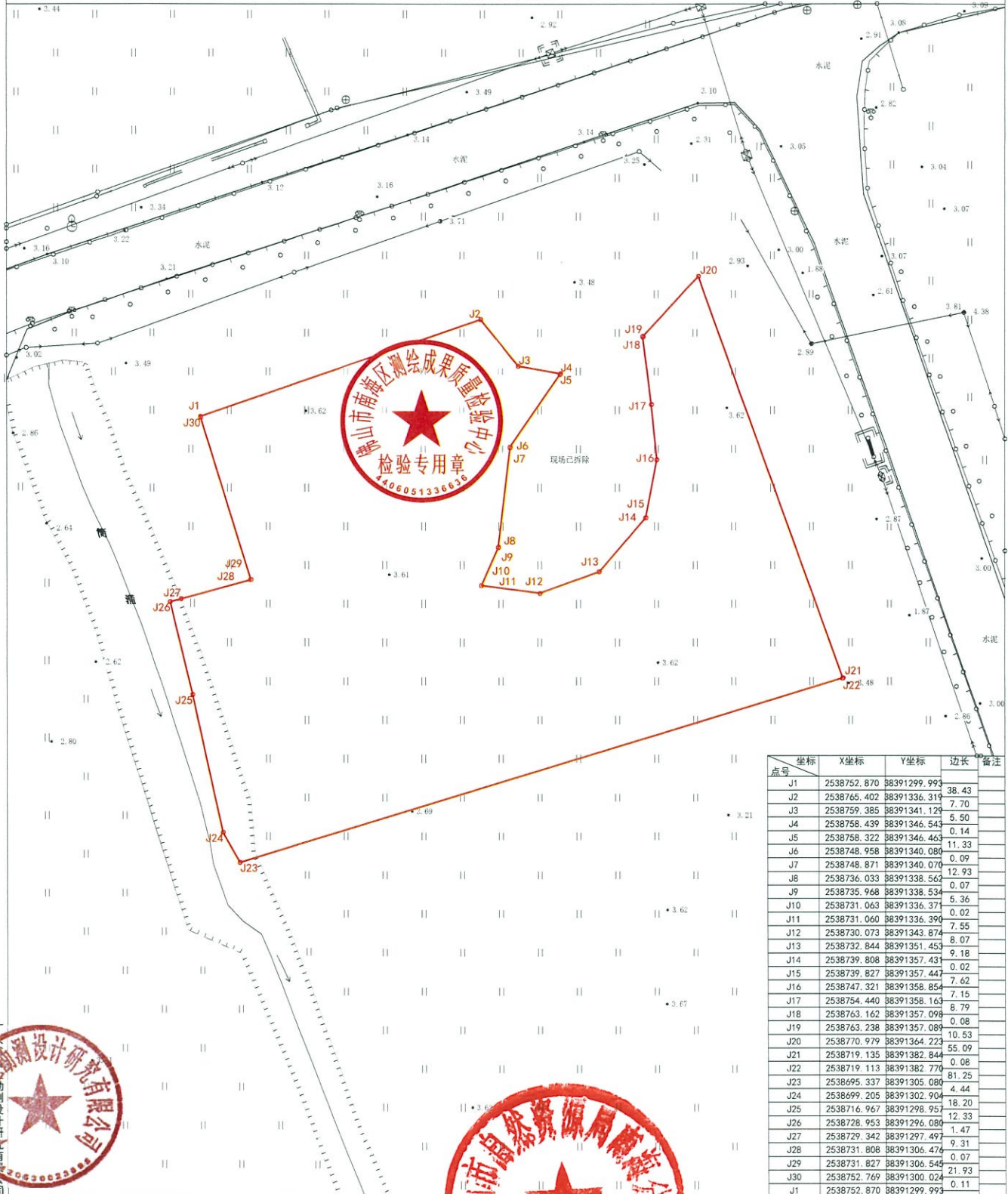

地块编号: YDBP44060500401176
 项目名称: 佛山市南海区西樵镇听音湖片区拓展区改造提升项目
 用地面积: 3634.27m²
 用地单位: 佛山市南海区西樵镇人民政府
 图形UID: [5EF163F0-1330-4BD9-B50A-F3AD727E89CD]
 土地座落: 广东省佛山市南海区西樵镇听音湖片区拓展区范围内



点号	坐标	X坐标	Y坐标	边长	备注
J1	2538752.870	88391299.993		38.43	
J2	2538765.402	88391336.319		7.70	
J3	2538759.385	88391341.129		5.50	
J4	2538758.439	88391346.543		0.14	
J5	2538758.322	88391346.463		11.33	
J6	2538748.958	88391340.080		0.09	
J7	2538748.871	88391340.070		12.93	
J8	2538736.033	88391338.562		0.07	
J9	2538735.968	88391338.534		5.36	
J10	2538731.063	88391336.371		7.52	
J11	2538731.060	88391336.390		0.05	
J12	2538730.073	88391343.874		8.07	
J13	2538732.844	88391351.453		9.18	
J14	2538739.808	88391357.431		0.02	
J15	2538739.827	88391357.447		7.62	
J16	2538747.321	88391358.854		7.15	
J17	2538754.440	88391358.163		8.79	
J18	2538763.162	88391357.098		0.08	
J19	2538763.238	88391357.089		10.53	
J20	2538770.979	88391364.223		55.09	
J21	2538719.135	88391382.844		0.08	
J22	2538719.113	88391382.770		81.25	
J23	2538695.337	88391305.080		4.44	
J24	2538699.205	88391302.904		18.20	
J25	2538716.967	88391298.951		12.33	
J26	2538728.953	88391296.080		1.47	
J27	2538729.342	88391297.497		9.31	
J28	2538731.808	88391306.476		0.07	
J29	2538731.827	88391306.545		21.93	
J30	2538752.769	88391300.024		0.11	
J1	2538752.870	88391299.993			



2000国家大地坐标系
 1985国家高程基准
 土地利用现状分类GB/T21010-2017

1:500

测量员: 韩巧寅 测量日期: 2022-9-8
 绘图员: 韩巧寅 绘图日期: 2022-9-8
 检查员: 张良超 检查日期: 2022-9-8

业务编号: 20221110000242

用地红线图



单位: m, m'

地块编号: YDBP44060500401308
 项目名称: 佛山市南海区西樵镇听音湖片区拓展区改造提升项目
 用地面积: 683.16m'
 用地单位: 佛山市南海区西樵镇人民政府
 图形ID: {4E3F8D3E-80F6-427E-A7D3-210B2F83C082}
 土地座落: 广东省佛山市南海区西樵镇听音湖片区拓展区范围内

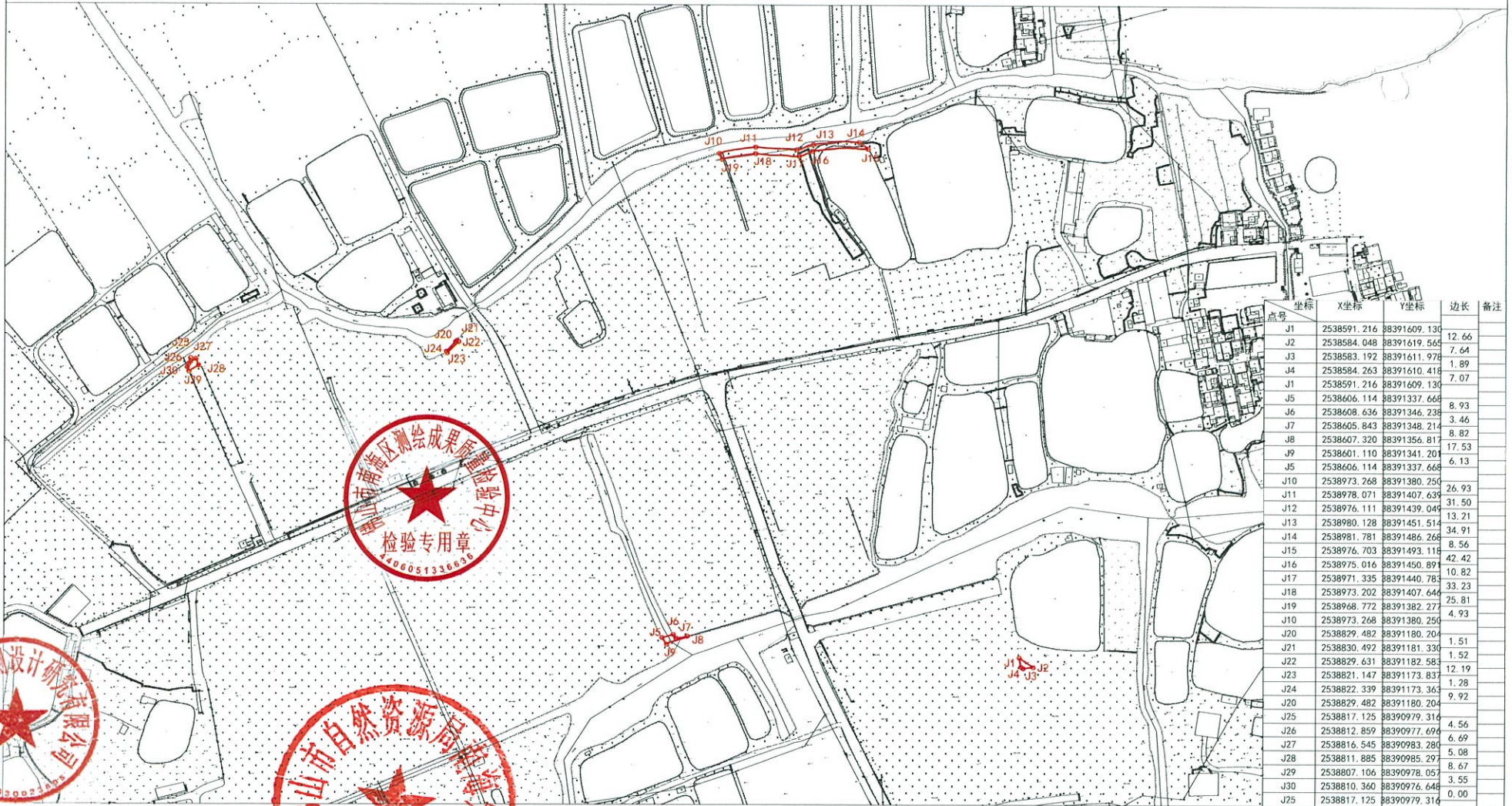

点号	X坐标	Y坐标	边长	备注
J1	2538591.216	88391609.130	12.66	
J2	2538584.048	88391619.565	7.64	
J3	2538583.192	88391611.978	1.89	
J4	2538584.263	88391610.418	7.07	
J1	2538591.216	88391609.130		
J5	2538606.114	88391337.668	8.93	
J6	2538608.636	88391346.238	3.46	
J7	2538605.843	88391348.214	8.82	
J8	2538607.320	88391356.817	17.53	
J9	2538601.110	88391341.201	6.13	
J5	2538606.114	88391337.668		
J10	2538973.268	88391380.250	26.93	
J11	2538978.071	88391407.639	31.50	
J12	2538976.111	88391439.049	13.21	
J13	2538980.128	88391451.514	34.91	
J14	2538981.781	88391486.268	8.56	
J15	2538976.703	88391493.118	42.42	
J16	2538975.016	88391450.891	10.82	
J17	2538971.335	88391440.783	33.23	
J18	2538973.202	88391407.644	25.81	
J19	2538968.772	88391382.277	4.93	
J10	2538973.268	88391380.250		
J20	2538829.482	88391180.204	1.51	
J21	2538830.492	88391181.330	1.52	
J22	2538829.631	88391182.583	12.19	
J23	2538821.147	88391173.837	1.28	
J24	2538822.339	88391173.363	9.92	
J20	2538829.482	88391180.204		
J25	2538817.125	88390979.316	4.56	
J26	2538812.859	88390977.694	6.69	
J27	2538816.545	88390983.280	5.08	
J28	2538811.885	88390985.297	8.67	
J29	2538807.106	88390978.057	3.55	
J30	2538810.360	88390976.648	0.00	
J25	2538817.125	88390979.316		



2000国家大地坐标系
 1985国家高程基准
 土地利用现状分类GB/T21010-2017

1:3000

测量员: 韩巧寅 测量日期: 2022-11-15
 绘图员: 韩巧寅 绘图日期: 2022-11-15
 检查员: 张良超 检查日期: 2022-11-15

用地红线图



单位: m

地块编号 YDBF-4-00500401312
 项目名称 佛山市南海区西樵镇听音湖片区拓展区改造提升项目
 用地面积 77335.28m²
 用地单位 佛山市南海区西樵镇人民政府
 图号J10 [2818C340-0380-4087-8967-1]07C250046C
 土地用途: 广东省佛山市南海区西樵镇听音湖片区拓展区范围内

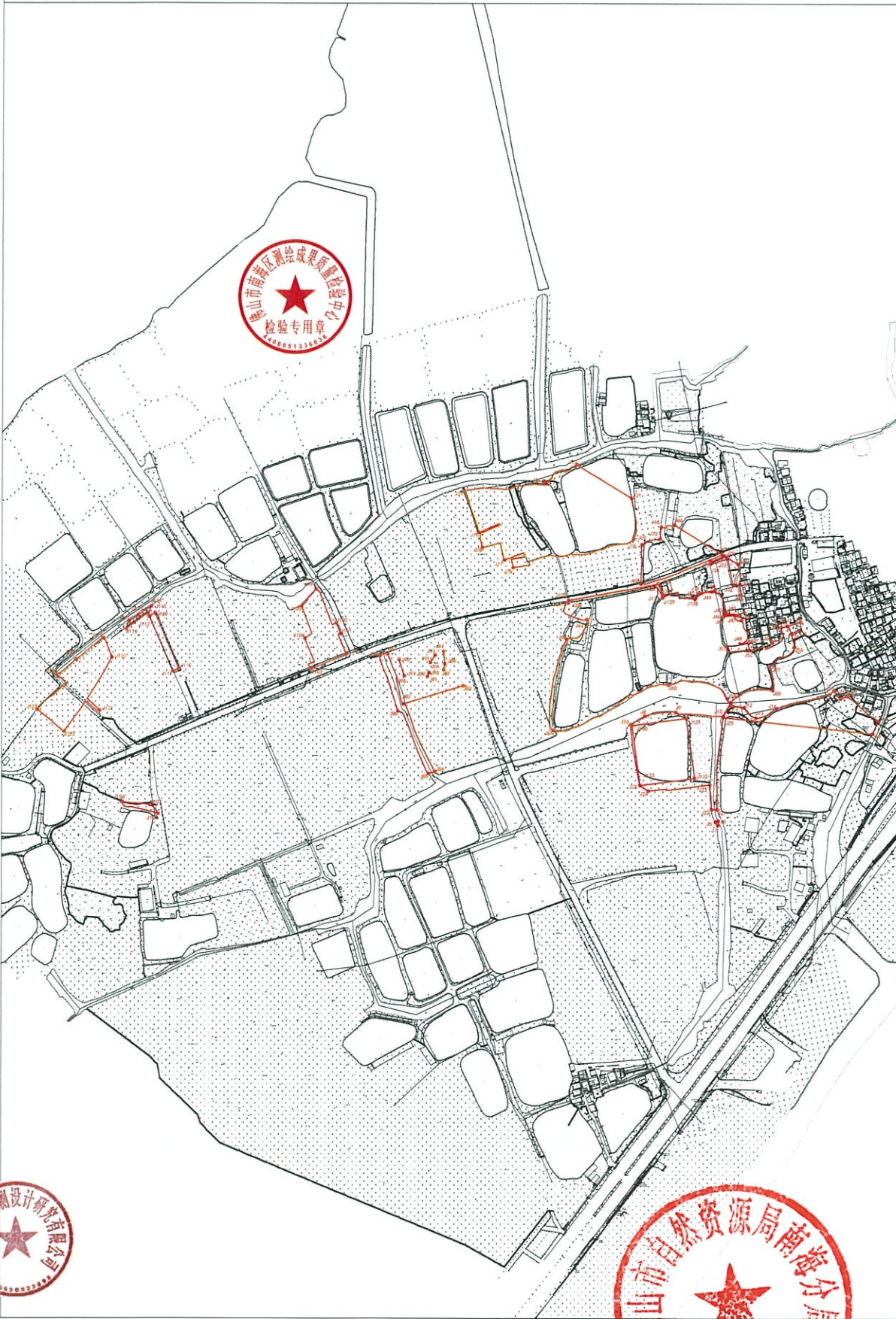

点号	点名称	坐标	长度	备注
J1	253076.342	30391797.683	12.22	
J2	253080.531	30391814.817	12.11	
J3	253078.738	30391813.648	11.13	
J4	253075.613	30391793.323	12.30	
J1	253076.342	30391797.683		
J5	253054.627	30391754.843	6.06	
J6	253058.021	30391756.578	5.94	
J7	253059.995	30391756.238	46.22	
J8	253060.177	30391753.003	17.87	
J9	253060.279	30391748.505	40.52	
J10	253060.214	30391715.302	17.87	
J11	253060.643	30391723.518	20.80	
J12	253061.420	30391730.518	17.87	
J13	253061.250	30391730.518	17.87	
J14	253060.332	30391731.899	17.87	
J15	253071.143	30391696.118	13.19	
J16	253070.184	30391686.228	13.19	
J17	253070.184	30391675.238	13.19	
J18	253067.740	30391675.238	13.19	
J19	253067.740	30391675.238	13.19	
J20	253067.740	30391675.238	13.19	
J21	253060.352	30391707.181	13.19	
J22	253060.480	30391706.279	13.19	
J23	253060.422	30391696.228	13.19	
J24	253060.048	30391696.228	13.19	
J25	253060.216	30391696.228	13.19	
J26	253060.120	30391686.228	13.19	
J27	253060.181	30391615.000	13.19	
J28	253060.770	30391615.000	13.19	
J29	253060.240	30391721.834	13.19	
J30	253060.054	30391721.834	13.19	
J31	253060.818	30391721.834	13.19	
J32	253060.540	30391721.834	13.19	
J33	253060.468	30391721.834	13.19	
J34	253060.600	30391696.228	13.19	
J35	253060.730	30391696.228	13.19	
J36	253060.430	30391511.888	13.19	
J37	253060.327	30391632.214	13.19	
J38	253060.240	30391721.834	13.19	
J39	253060.054	30391721.834	13.19	
J40	253060.818	30391721.834	13.19	
J41	253060.540	30391721.834	13.19	
J42	253060.468	30391721.834	13.19	
J43	253060.600	30391696.228	13.19	
J44	253060.730	30391696.228	13.19	
J45	253060.430	30391511.888	13.19	
J46	253060.327	30391632.214	13.19	
J47	253060.240	30391721.834	13.19	
J48	253060.054	30391721.834	13.19	
J49	253060.818	30391721.834	13.19	
J50	253060.540	30391721.834	13.19	
J51	253060.468	30391721.834	13.19	
J52	253060.600	30391696.228	13.19	
J53	253060.730	30391696.228	13.19	
J54	253060.430	30391511.888	13.19	
J55	253060.327	30391632.214	13.19	
J56	253060.240	30391721.834	13.19	
J57	253060.054	30391721.834	13.19	
J58	253060.818	30391721.834	13.19	
J59	253060.540	30391721.834	13.19	
J60	253060.468	30391721.834	13.19	
J61	253060.600	30391696.228	13.19	
J62	253060.730	30391696.228	13.19	
J63	253060.430	30391511.888	13.19	
J64	253060.327	30391632.214	13.19	
J65	253060.240	30391721.834	13.19	
J66	253060.054	30391721.834	13.19	
J67	253060.818	30391721.834	13.19	
J68	253060.540	30391721.834	13.19	
J69	253060.468	30391721.834	13.19	
J70	253060.600	30391696.228	13.19	
J71	253060.730	30391696.228	13.19	
J72	253060.430	30391511.888	13.19	
J73	253060.327	30391632.214	13.19	
J74	253060.240	30391721.834	13.19	
J75	253060.054	30391721.834	13.19	
J76	253060.818	30391721.834	13.19	
J77	253060.540	30391721.834	13.19	
J78	253060.468	30391721.834	13.19	
J79	253060.600	30391696.228	13.19	
J80	253060.730	30391696.228	13.19	
J81	253060.430	30391511.888	13.19	
J82	253060.327	30391632.214	13.19	
J83	253060.240	30391721.834	13.19	
J84	253060.054	30391721.834	13.19	
J85	253060.818	30391721.834	13.19	
J86	253060.540	30391721.834	13.19	
J87	253060.468	30391721.834	13.19	
J88	253060.600	30391696.228	13.19	
J89	253060.730	30391696.228	13.19	
J90	253060.430	30391511.888	13.19	
J91	253060.327	30391632.214	13.19	
J92	253060.240	30391721.834	13.19	
J93	253060.054	30391721.834	13.19	
J94	253060.818	30391721.834	13.19	
J95	253060.540	30391721.834	13.19	
J96	253060.468	30391721.834	13.19	
J97	253060.600	30391696.228	13.19	
J98	253060.730	30391696.228	13.19	
J99	253060.430	30391511.888	13.19	
J100	253060.327	30391632.214	13.19	
J101	253060.240	30391721.834	13.19	
J102	253060.054	30391721.834	13.19	
J103	253060.818	30391721.834	13.19	
J104	253060.540	30391721.834	13.19	
J105	253060.468	30391721.834	13.19	
J106	253060.600	30391696.228	13.19	
J107	253060.730	30391696.228	13.19	
J108	253060.430	30391511.888	13.19	
J109	253060.327	30391632.214	13.19	
J110	253060.240	30391721.834	13.19	
J111	253060.054	30391721.834	13.19	
J112	253060.818	30391721.834	13.19	
J113	253060.540	30391721.834	13.19	
J114	253060.468	30391721.834	13.19	
J115	253060.600	30391696.228	13.19	
J116	253060.730	30391696.228	13.19	
J117	253060.430	30391511.888	13.19	
J118	253060.327	30391632.214	13.19	
J119	253060.240	30391721.834	13.19	
J120	253060.054	30391721.834	13.19	
J121	253060.818	30391721.834	13.19	
J122	253060.540	30391721.834	13.19	
J123	253060.468	30391721.834	13.19	
J124	253060.600	30391696.228	13.19	
J125	253060.730	30391696.228	13.19	
J126	253060.430	30391511.888	13.19	
J127	253060.327	30391632.214	13.19	
J128	253060.240	30391721.834	13.19	
J129	253060.054	30391721.834	13.19	
J130	253060.818	30391721.834	13.19	
J131	253060.540	30391721.834	13.19	
J132	253060.468	30391721.834	13.19	
J133	253060.600	30391696.228	13.19	
J134	253060.730	30391696.228	13.19	
J135	253060.430	30391511.888	13.19	
J136	253060.327	30391632.214	13.19	
J137	253060.240	30391721.834	13.19	
J138	253060.054	30391721.834	13.19	
J139	253060.818	30391721.834	13.19	
J140	253060.540	30391721.834	13.19	
J141	253060.468	30391721.834	13.19	
J142	253060.600	30391696.228	13.19	
J143	253060.730	30391696.228	13.19	
J144	253060.430	30391511.888	13.19	
J145	253060.327	30391632.214	13.19	
J146	253060.240	30391721.834	13.19	
J147	253060.054	30391721.834	13.19	
J148	253060.818	30391721.834	13.19	
J149	253060.540	30391721.834	13.19	
J150	253060.468	30391721.834	13.19	



2000国家大地坐标系
 1985国家高程基准
 土地利用现状分类GB/T21010-2017

1:8500

测量员 韩巧英
 绘图员 韩巧英
 检查员 张良超

测量日期: 2022-11-15
 绘图日期: 2022-11-15
 检查日期: 2022-11-15

业务编号: 202209030000056

用地红线图



单位: m, m²

地块编号: YDBP44060500401177
 项目名称: 佛山市南海区西樵镇听音湖片区拓展区改造提升项目
 用地面积: 5443.64m²
 用地单位: 佛山市南海区西樵镇人民政府
 图形GUID: {039D5C5C-7B0A-4889-ABEB-BBED4F7C1DEE}
 土地座落: 广东省佛山市南海区西樵镇听音湖片区拓展区范围内

北

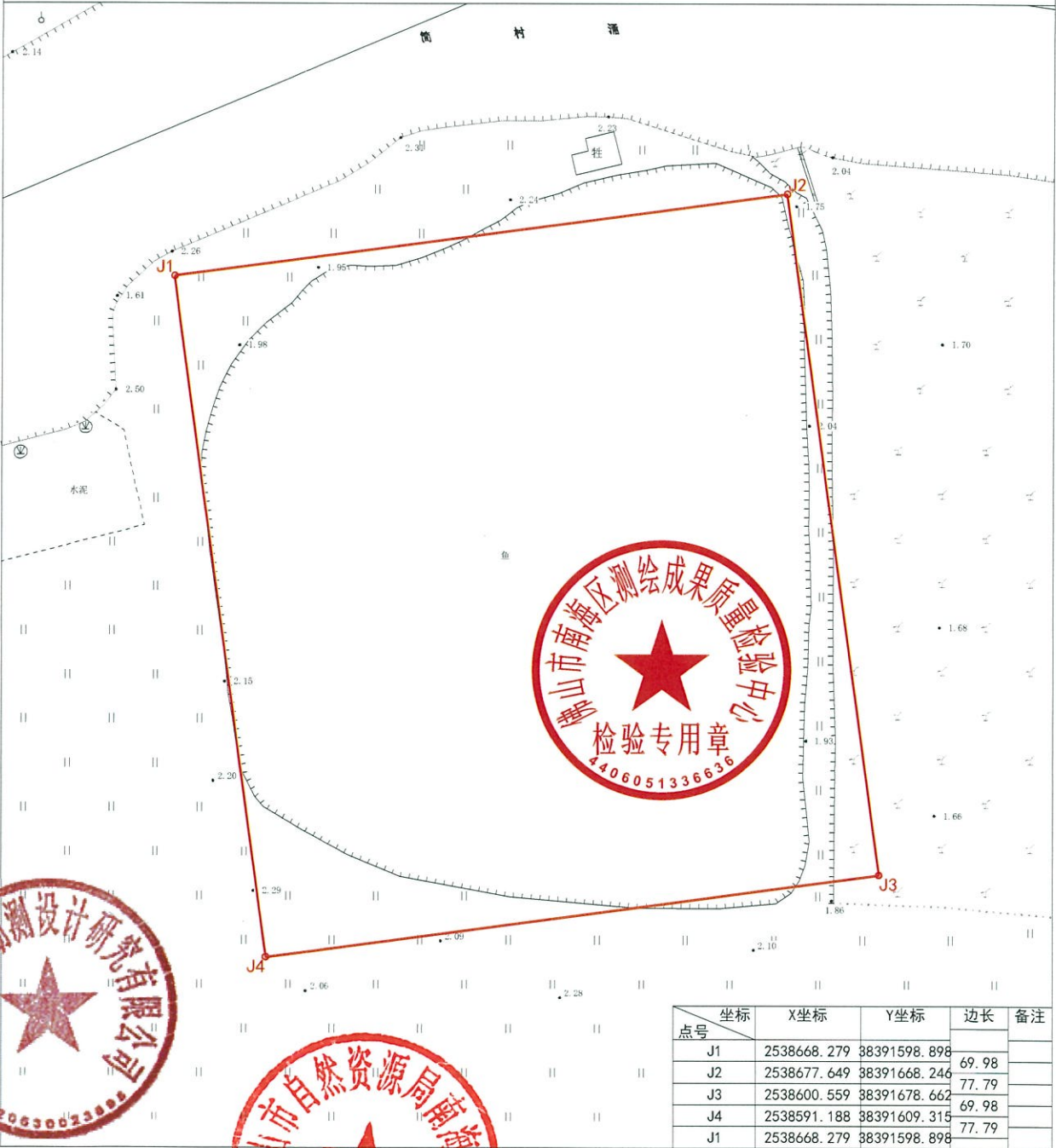

点号	坐标	X坐标	Y坐标	边长	备注
J1		2538668.279	38391598.898	69.98	
J2		2538677.649	38391668.246	77.79	
J3		2538600.559	38391678.662	69.98	
J4		2538591.188	38391609.315	77.79	
J1		2538668.279	38391598.898		

2000国家大地坐标系

1985国家高程基准

土地利用现状分类GB/T21010-2017

1:700

测量员: 韩巧寅

绘图员: 韩巧寅

检查员: 张良超

测量日期: 2022-9-8

绘图日期: 2022-9-8

检查日期: 2022-9-8